

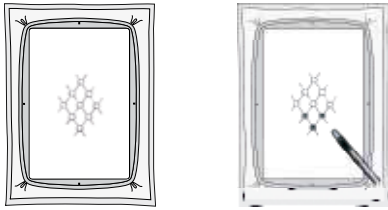

○ Eyelet



✧ Wing needle



△ Pop-up embroidery

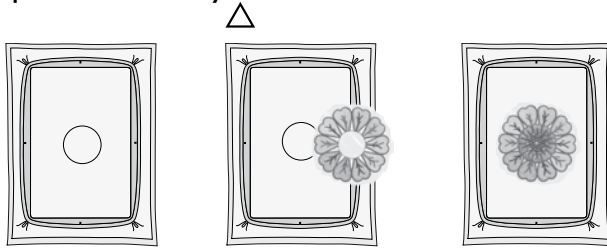

✂ Cutwork

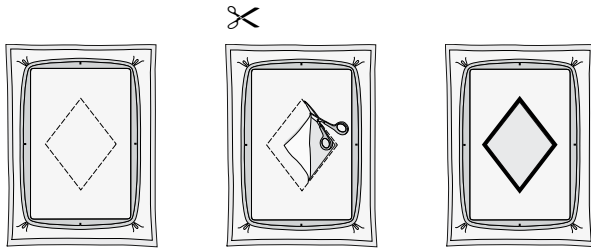

● Appliqué

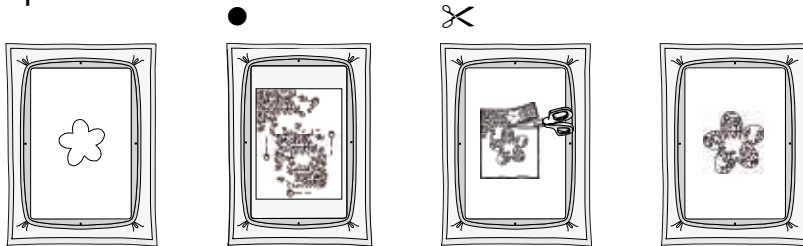

💧 Free standing design

● Heavy weight  
water soluble



\* Chenille

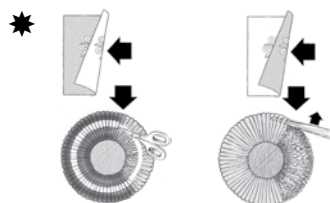

Endless (E)

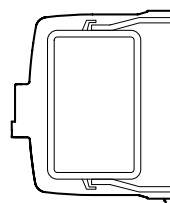

Yarn Couching



## Cutwork needle embroidery

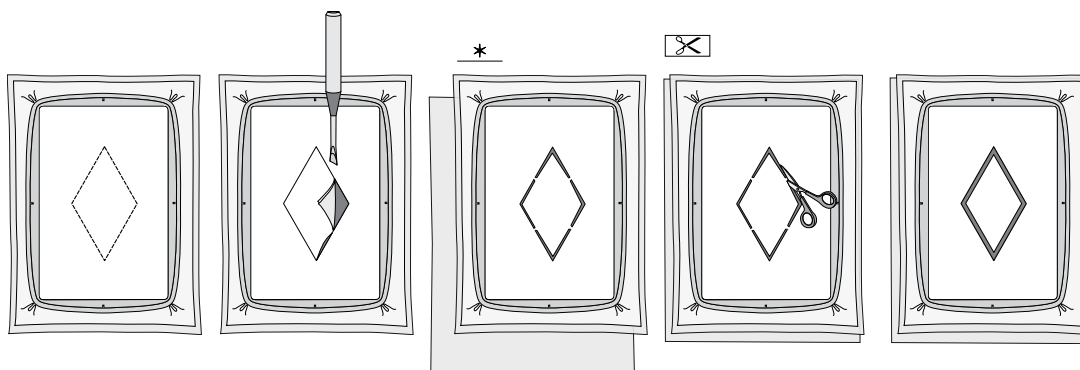

(✂) Cut inside marked area if not using INSPIRA™ Cutwork Needles

\* Add a new water soluble stabilizer underneath

✂ Trim and remove the cut fabric if using INSPIRA™ Cutwork Needles

🪡 Clean the bobbin area

 Needle #1 INSPIRA™ Cutwork Needles

 Needle #2 INSPIRA™ Cutwork Needles

 Needle #3 INSPIRA™ Cutwork Needles

 Needle #4 INSPIRA™ Cutwork Needles

Remove needle thread when using INSPIRA™ Cutwork Needles.

## Cutting instructions to finish THREAD VELVET™ Embroidery:

To create the THREAD VELVET™ effect, cut the satin stitch down the middle from the right side.

Avoid cutting the very last underlay of stitches for the best result.

To secure the thread for laundering, add textile glue to the wrong side of the embroidery to secure the threads.

✂ THREAD VELVET™



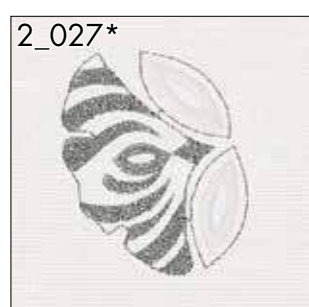
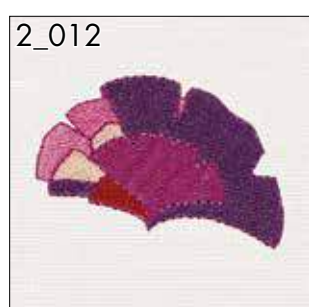
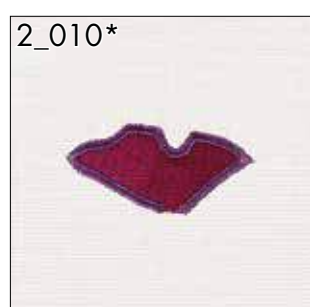
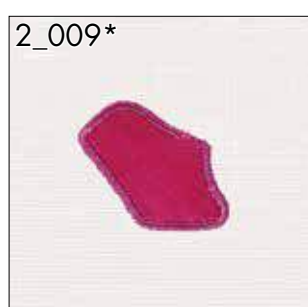
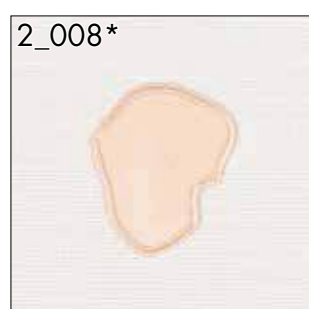
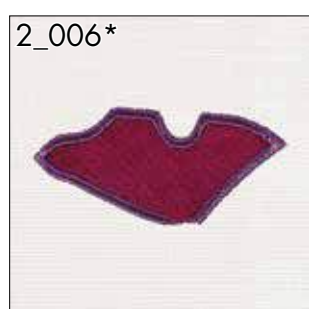
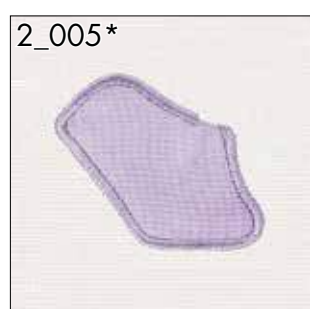
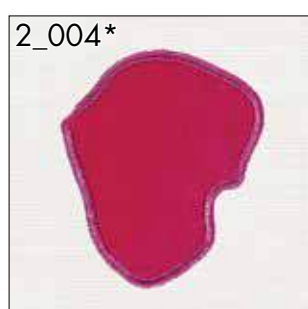
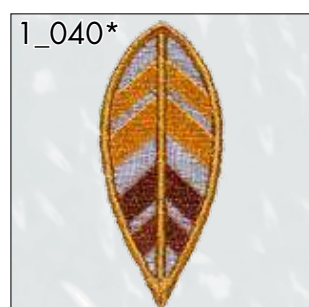
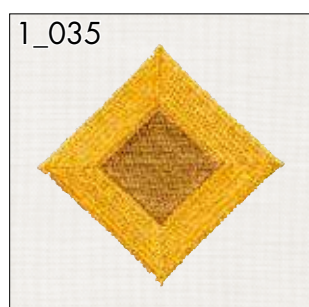
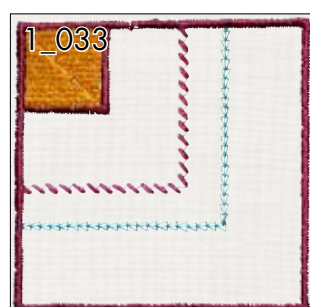
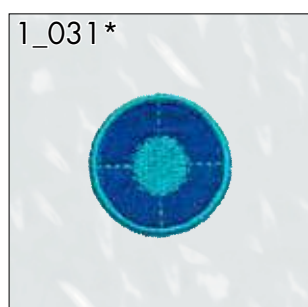
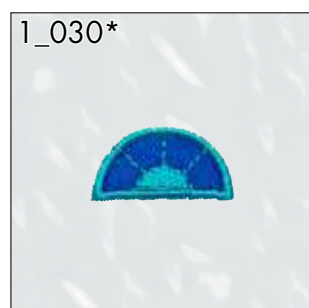
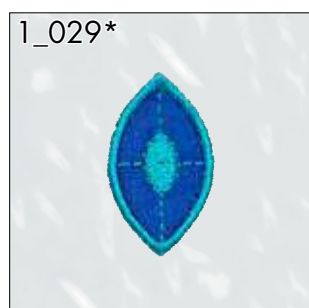
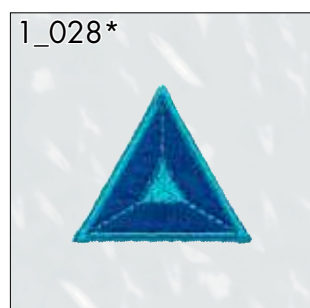
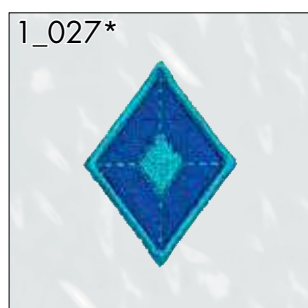
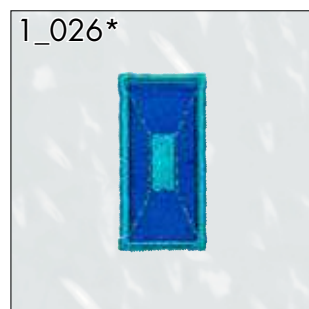
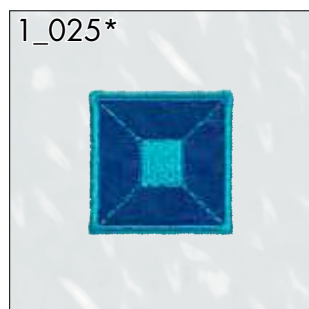
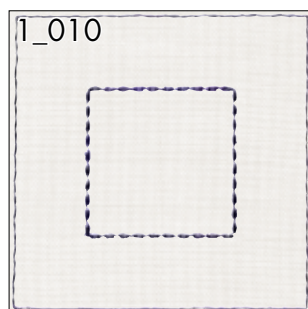
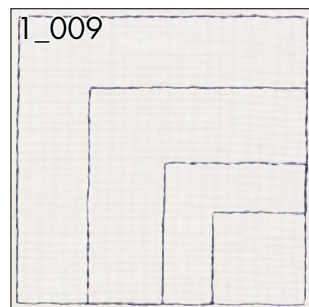
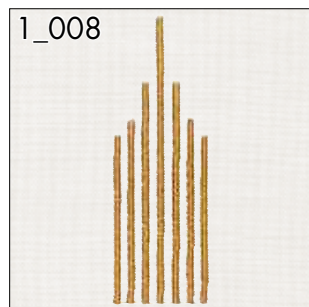
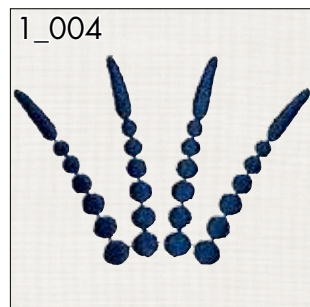
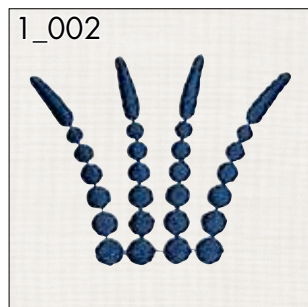

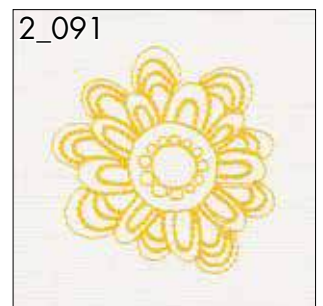
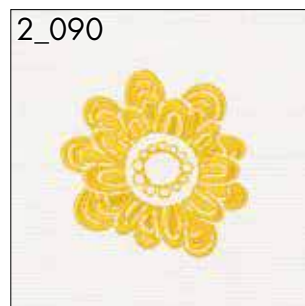
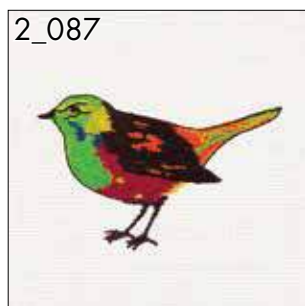
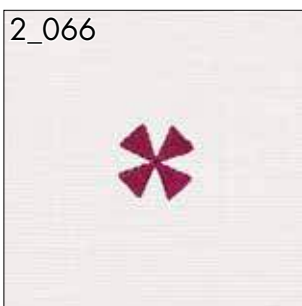
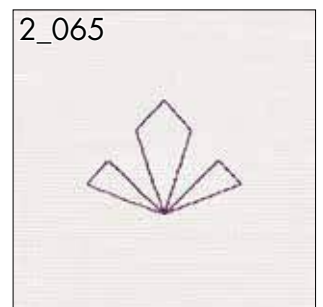
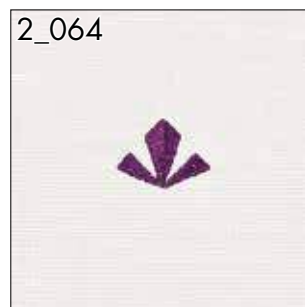
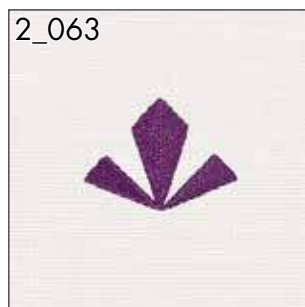
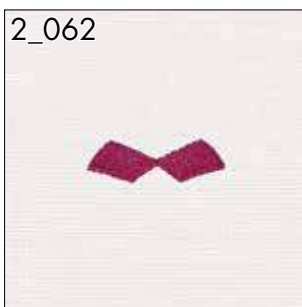
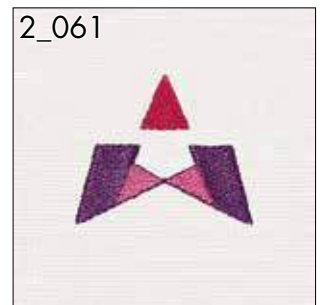
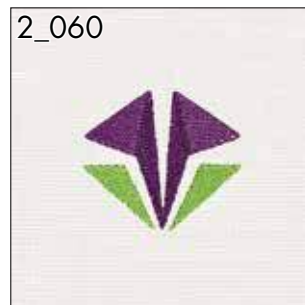
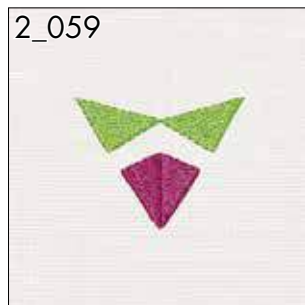
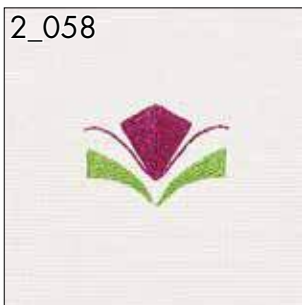
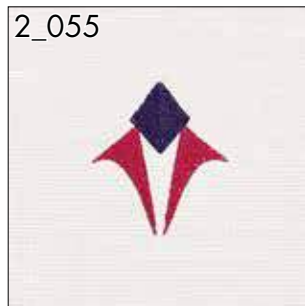
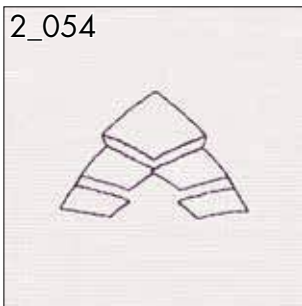
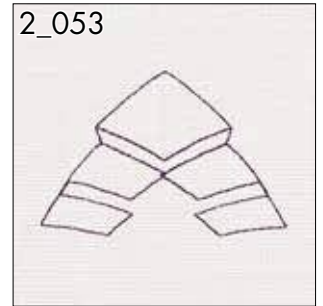
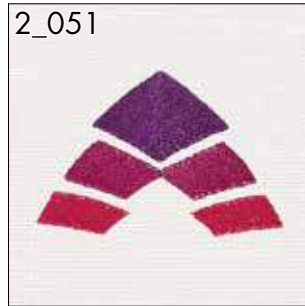
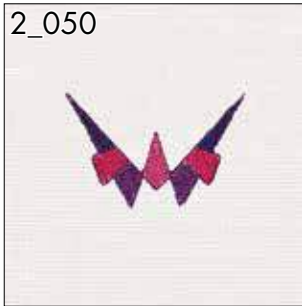
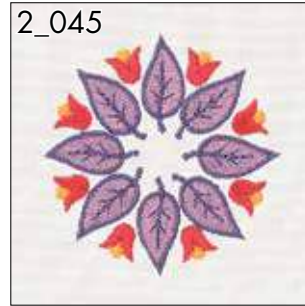
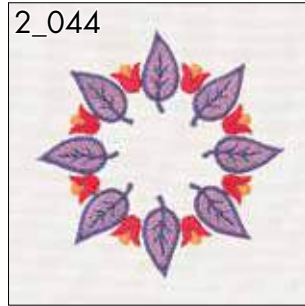
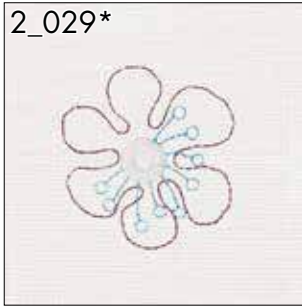



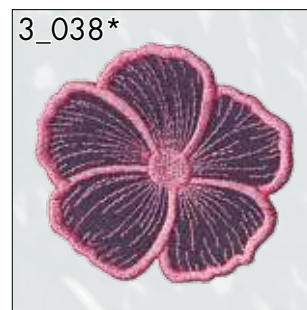
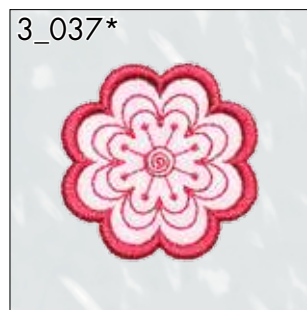
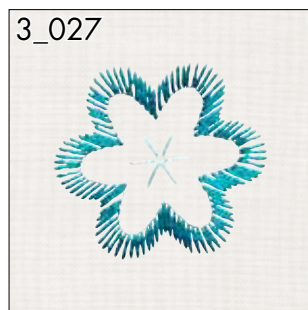
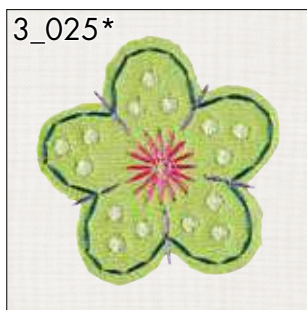
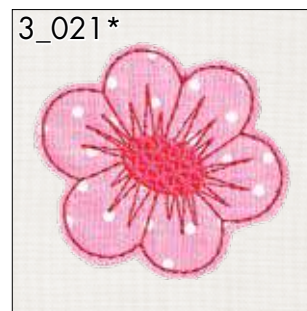
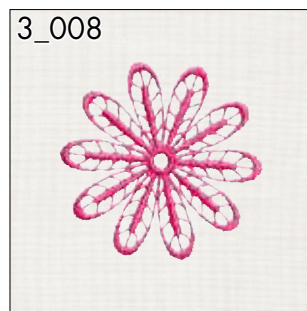
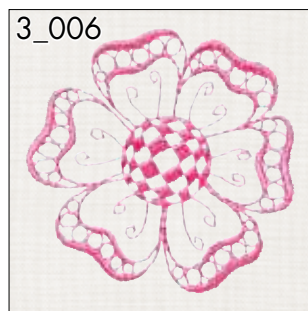
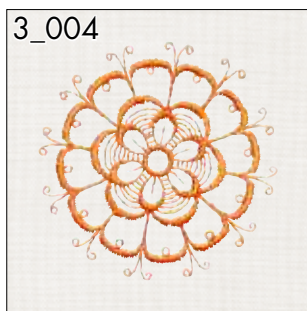
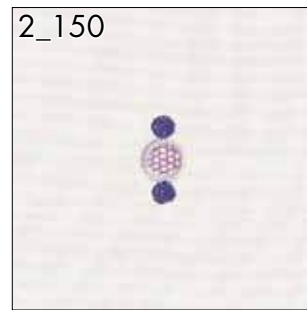
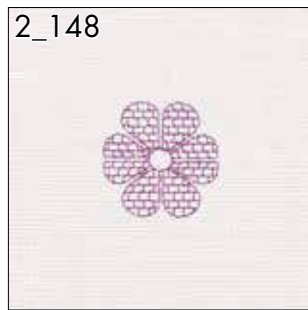
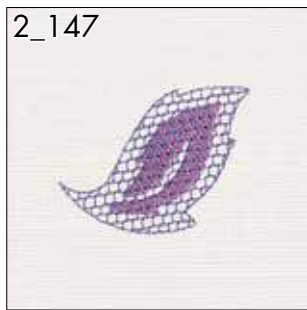
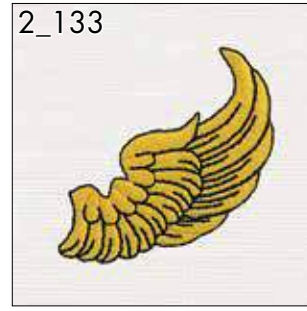
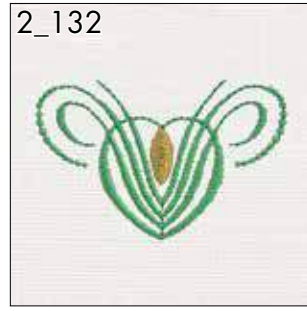
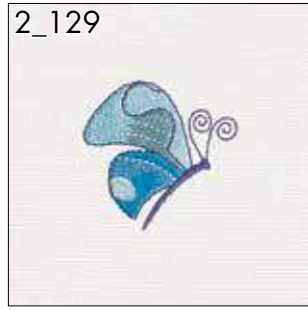
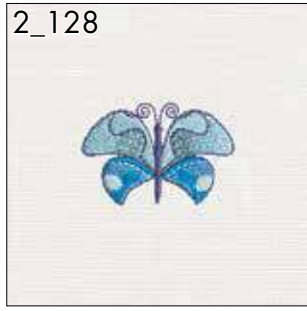
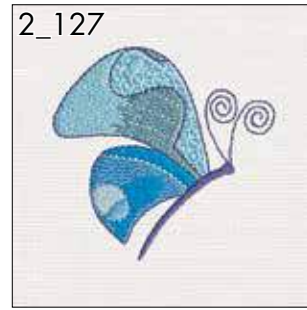
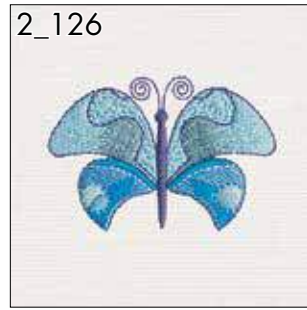
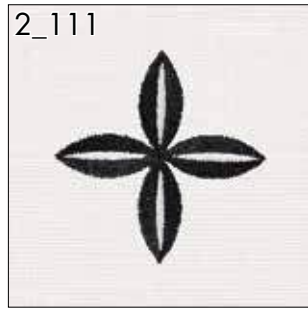
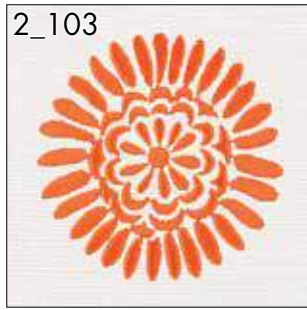

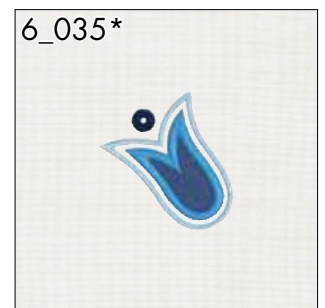
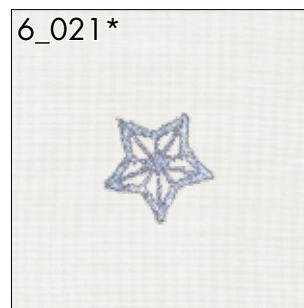
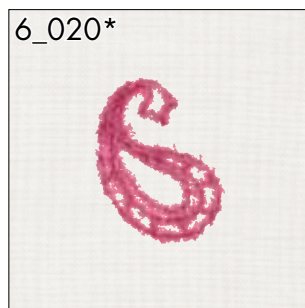
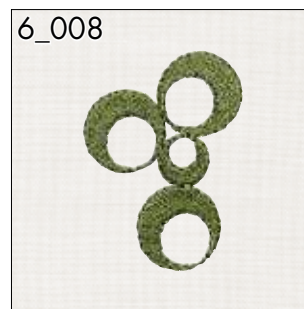
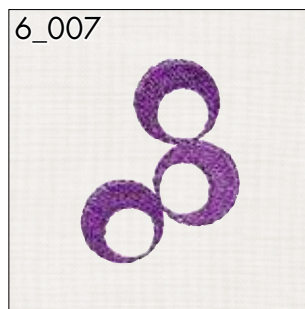
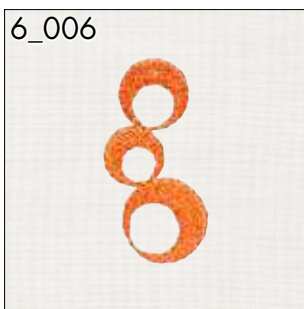
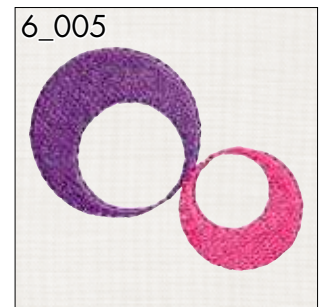
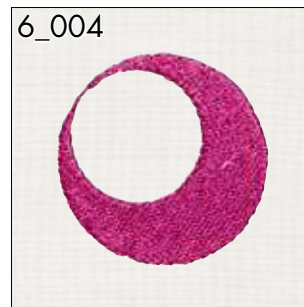
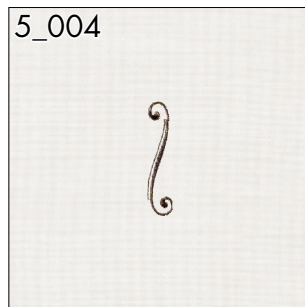
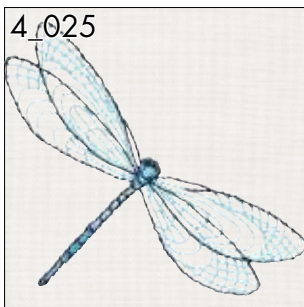
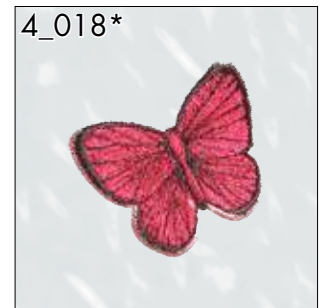
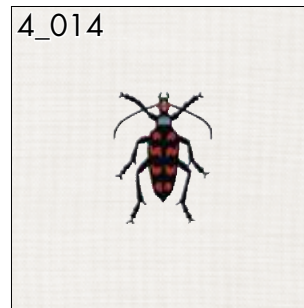
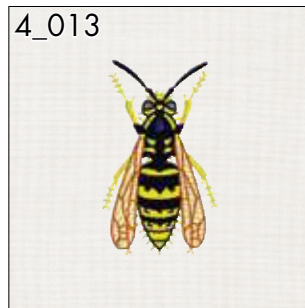
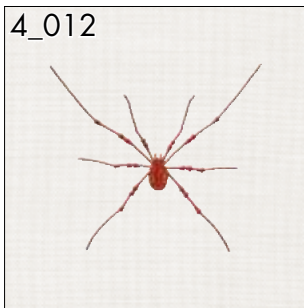
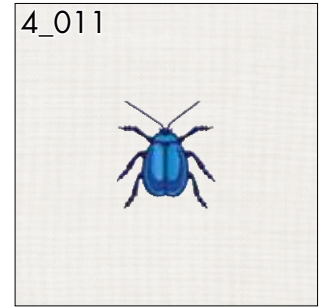
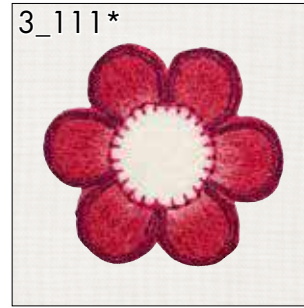
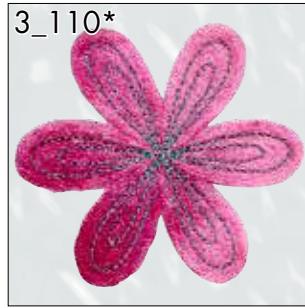
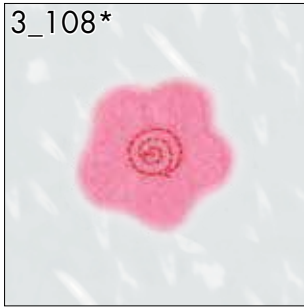
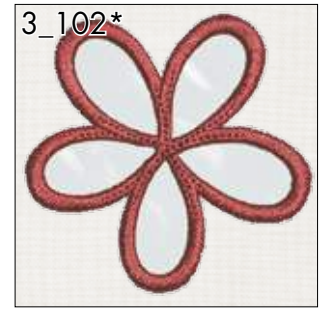
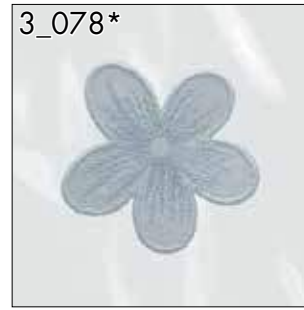
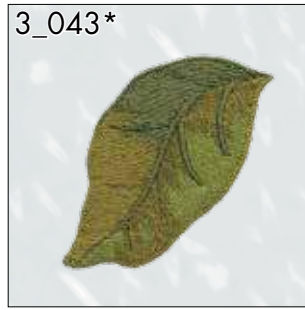
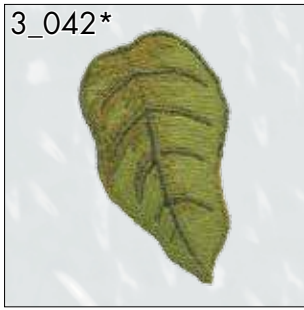



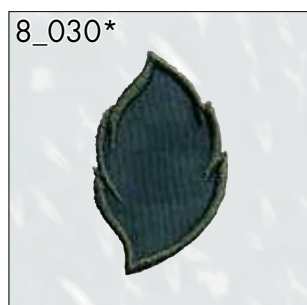
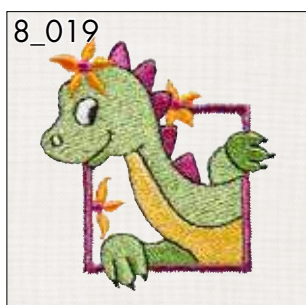
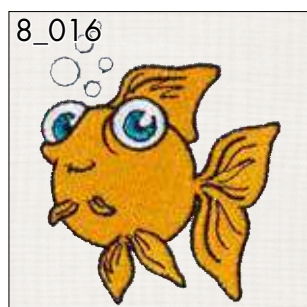
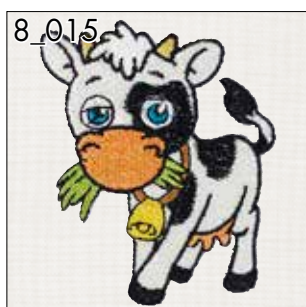
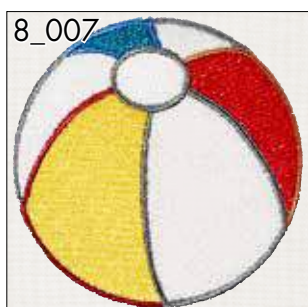
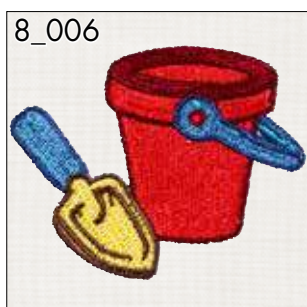
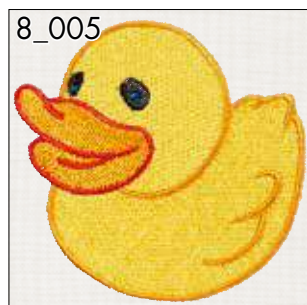
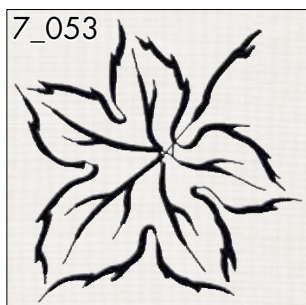
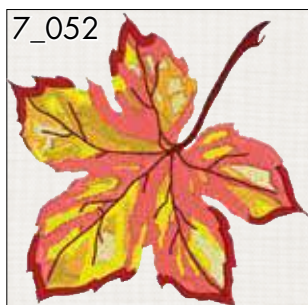
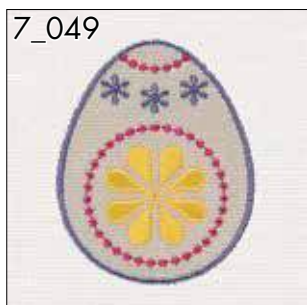
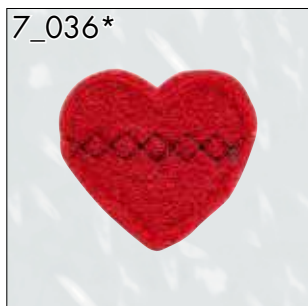
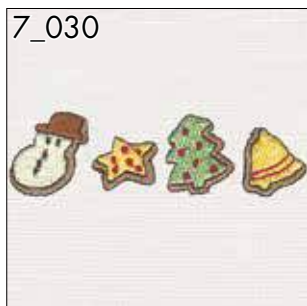
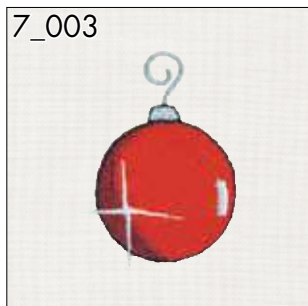
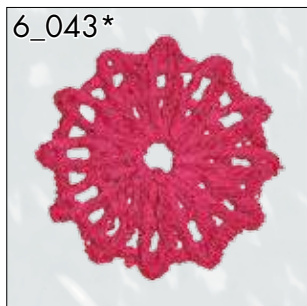
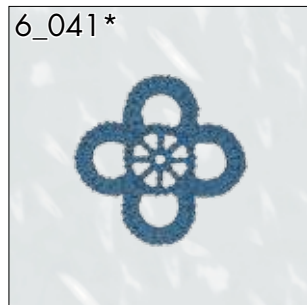
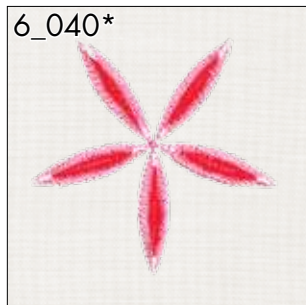
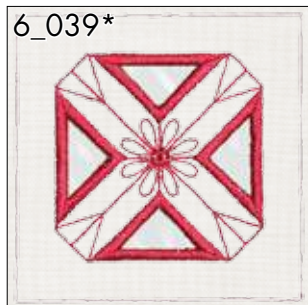
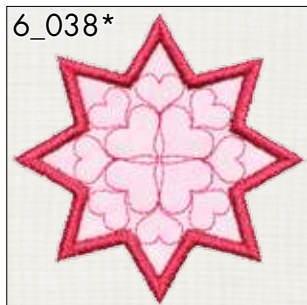



8\_031\*



8\_035



8\_036



8\_037



8\_046



8\_049



8\_050



8\_051



8\_052



8\_054



8\_055



8\_056



10\_015

cappuccino

10\_016

java

10\_017

ristretto

10\_018

espresso

10\_019

frappé

10\_020

latte

10\_021

macchiato

10\_022

mocha

10\_023



10\_024

tea

10\_028

Chai

10\_029

Rooibos

